

dimensioni espresse in mm

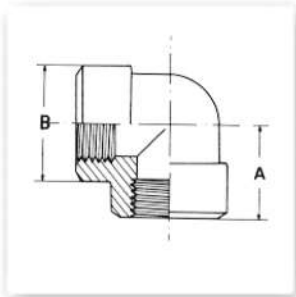

Gomiti a 90° ASTM A105 A182 F304/304L F316/316L

Ø		1/8"	1/4"	3/8"	1/2"	3/4"	1"	1.1/4"	1.1/2"	2"	2.1/2"	3"	4"
2000	A	20.6	20.6	24.6	28.5	33.3	38.1	44.5	50.8	60.5	76.2	85.9	106.4
	B	22.4	22.4	25.4	33.3	38.1	46.5	55.6	62.0	75.4	92.0	109.5	146.0
3000	A	20.6	24.6	28.5	33.3	38.1	44.5	50.8	60.5	63.5	82.6	95.3	114.3
	B	22.4	25.4	33.3	38.1	46.0	55.6	62.0	75.4	84.1	101.6	120.6	152.4
6000	A	24.6	28.5	33.3	38.1	44.5	50.8	60.5	76.2	82.6	95.3	106.4	114.3
	B	25.4	33.3	38.1	46.0	55.6	62.0	75.4	84.1	101.6	120.6	146.0	152.4

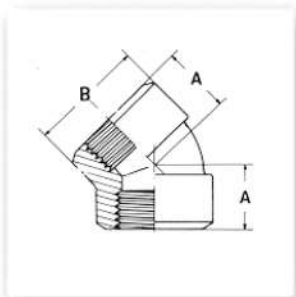

Gomiti a 45° ASTM A105 A182 F304/304L F316/316L

Ø		1/8"	1/4"	3/8"	1/2"	3/4"	1"	1.1/4"	1.1/2"	2"	2.1/2"	3"	4"
2000	A	17.5	17.5	19.0	22.4	25.4	28.5	33.3	35.0	42.9	52.3	63.5	79.2
	B	22.4	22.4	25.4	33.3	38.1	46.5	55.6	62.0	75.4	92.0	109.5	146.0
3000	A	17.5	19.0	22.4	25.4	28.5	33.3	35.0	42.9	43.7	52.3	63.5	79.2
	B	22.4	25.4	33.3	38.1	46.0	55.6	62.0	75.4	84.1	101.6	120.6	152.4
6000	A	19.0	22.4	25.4	28.5	33.3	35.0	42.9	47.3	52.3	63.5	79.2	79.2
	B	25.4	33.3	38.1	46.0	55.6	62.0	75.4	84.1	101.6	120.6	146.0	152.4

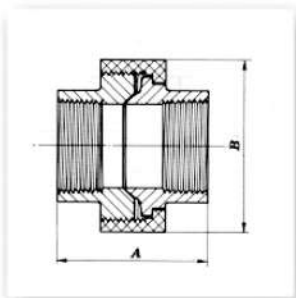

Bocchettoni ASTM A105 A182 F304/304L F316/316L

Ø		1/8"	1/4"	3/8"	1/2"	3/4"	1"	1.1/4"	1.1/2"	2"	2.1/2"	3"	4"
2/3000	A	41.4	41.4	46.0	49.0	56.9	62.0	71.1	76.5	86.1	118.0	109.0	153.0
	B	35.0	35.0	40.0	46.0	55.5	64.5	78.0	87.0	104.0	124.0	150.0	187.0
6000	A		49.0	49.0	62.0	62.0	76.5	76.5	86.1	118.0			
	B		46.0	46.0	64.5	64.5	87.0	87.0	104.0	124.0			

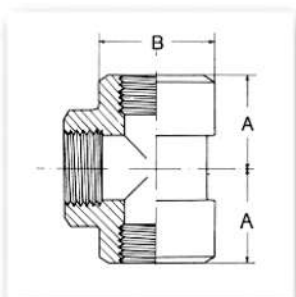

Tee normali ASTM A105 A182 F304/304L F316/316L

Ø		1/8"	1/4"	3/8"	1/2"	3/4"	1"	1.1/4"	1.1/2"	2"	2.1/2"	3"	4"
2000	A	20.6	20.6	24.6	28.5	33.3	38.1	44.5	50.8	60.5	76.2	85.9	106.4
	B	22.4	22.4	25.4	33.3	38.1	46.5	55.6	62.0	75.4	92.0	109.5	146.0
3000	A	20.6	24.6	28.5	33.3	38.1	44.5	50.8	60.5	63.5	82.6	95.3	114.3
	B	22.4	25.4	33.3	38.1	46.0	55.6	62.0	75.4	84.1	101.6	120.6	152.4
6000	A	24.6	28.5	33.3	38.1	44.5	50.8	60.5	76.2	82.6	95.3	106.4	114.3
	B	25.4	33.3	38.1	46.0	55.6	62.0	75.4	84.1	101.6	120.6	146.0	152.4

dimensioni espresse in mm

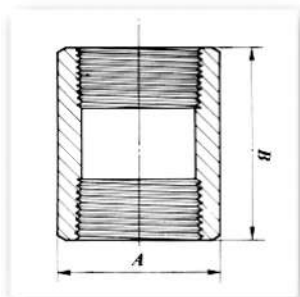

Manicotti ASTM A105 A182 F304/304L F316/316L

Ø		1/8"	1/4"	3/8"	1/2"	3/4"	1"	1.1/4"	1.1/2"	2"	2.1/2"	3"	4"
2/3000	A	15.7	19.0	22.3	28.5	35.0	44.5	57.1	63.5	76.2	91.9	107.9	139.7
	B	31.7	35.0	38.1	47.7	50.8	60.4	66.5	79.2	85.8	91.9	107.9	120.6
6000	A	22.3	25.4	31.7	38.1	44.5	57.1	63.5	76.2	91.9	107.9	127.0	18.7
	B	31.7	35.0	38.1	47.7	50.8	60.4	66.5	79.2	85.8	91.9	107.9	120.6

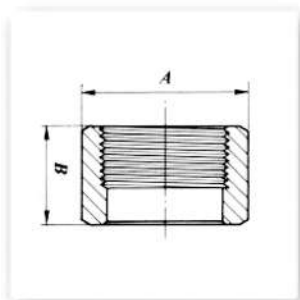

Mezzi manicotti ASTM A105 A182 F304/304L F316/316L

Ø		1/8"	1/4"	3/8"	1/2"	3/4"	1"	1.1/4"	1.1/2"	2"	2.1/2"	3"	4"
2/3000	A	15.7	19.0	22.3	28.5	35.0	44.5	57.1	63.5	76.2	91.9	107.9	139.7
	B	16	17.5	19	24	25.5	30	33	40	43	46	54	60
6000	A	22.3	25.4	31.7	38.1	44.5	57.1	63.5	76.2	91.9	107.9	127.0	18.7
	B	16	17.5	19	24	25.5	30	33	40	43	46	54	60

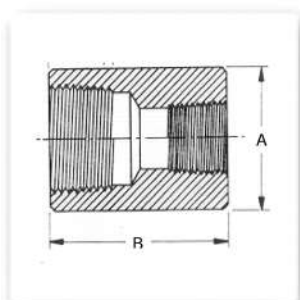

Manicotti Ridotti ASTM A105 A182 F304/304L F316/316L

Ø		1/8"	1/4"	3/8"	1/2"	3/4"	1"	1.1/4"	1.1/2"	2"	2.1/2"	3"	4"
2/3000	A	15.7	19.0	22.3	28.5	35.0	44.5	57.1	63.5	76.2	91.9	107.9	139.7
	B	31.7	35.0	38.1	47.7	50.8	60.4	66.5	79.2	85.8	91.9	107.9	120.6
6000	A	22.3	25.4	31.7	38.1	44.5	57.1	63.5	76.2	91.9	107.9	127.0	18.7
	B	31.7	35.0	38.1	47.7	50.8	60.4	66.5	79.2	85.8	91.9	107.9	120.6

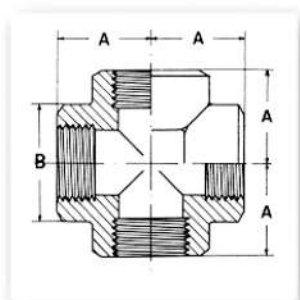

Croci ASTM A105 A182 F304/304L F316/316L

Ø		1/8"	1/4"	3/8"	1/2"	3/4"	1"	1.1/4"	1.1/2"	2"	2.1/2"	3"	4"
2000	A	20.6	20.6	24.6	28.5	33.3	38.1	44.5	50.8	60.5	76.2	85.9	106.4
	B	22.4	22.4	25.4	33.3	38.1	46.5	55.6	62.0	75.4	92.0	109.5	146.0
3000	A	20.6	24.6	28.5	33.3	38.1	44.5	50.8	60.5	63.5	82.6	95.3	114.3
	B	22.4	25.4	33.3	38.1	46.0	55.6	62.0	75.4	84.1	101.6	120.6	152.4
6000	A	24.6	28.5	33.3	38.1	44.5	50.8	60.5	76.2	82.6	95.3	106.4	114.3
	B	25.4	33.3	38.1	46.0	55.6	62.0	75.4	84.1	101.6	120.6	146.0	152.4

dimensioni espresse in mm

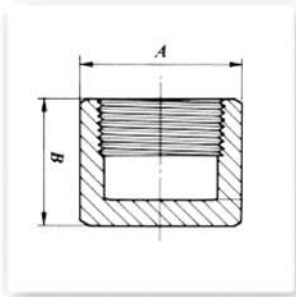

Tappi Femmina **ASTM A105 A182 F304/304L F316/316L**

Ø	1/8"	1/4"	3/8"	1/2"	3/4"	1"	1.1/4"	1.1/2"	2"	2.1/2"	3"	4"	
3/2000	A	15.7	19.0	22.3	28.5	35.0	44.5	57.1	63.5	76.2	91.9	107.9	139.7
	B	19.0	25.4	25.4	31.7	35.8	41.1	44.5	44.5	47.7	60.4	65.0	68.3
6000	A	22.3	25.4	31.7	38.1	44.5	57.1	63.5	76.2	91.9	107.9	127.0	18.7
	B	-	26.9	26.9	33.3	38.1	42.9	46.0	47.7	50.8	63.5	68.3	74.7

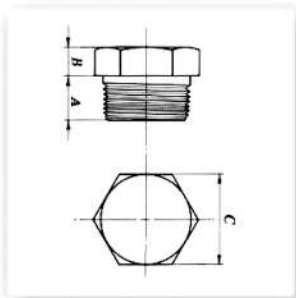

Tappi Testa Esagonale **ASTM A105 A182 F304/304L F316/316L**

Ø	1/8"	1/4"	3/8"	1/2"	3/4"	1"	1.1/4"	1.1/2"	2"	2.1/2"	3"	4"	
3/6000	A	9.6	11.2	12.7	14.2	15.7	19.0	20.6	20.6	22.3	26.9	28.4	31.7
	B	6.3	6.3	7.9	7.9	9.6	9.6	14.2	15.7	17.5	19.0	20.6	31.7
	C	11.0	16.0	17.5	22.0	27.0	35.0	44.5	51.0	63.5	76.0	89.0	117.5

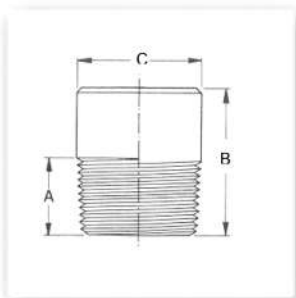

Tappi Testa Tonda **ASTM A105 A182 F304/304L F316/316L**

Ø	1/8"	1/4"	3/8"	1/2"	3/4"	1"	1.1/4"	1.1/2"	2"	2.1/2"	3"	4"	
3/6000	A	9.6	11.2	12.7	14.2	15.7	19.0	20.6	20.6	22.3	26.9	28.4	31.7
	B	6.5	7	8	9.5	11	13	15	16	18	19	21	32
	C	7.1	9.6	11.2	14.2	15.7	20.6	23.9	28.4	33.3	38.1	42.9	63.5

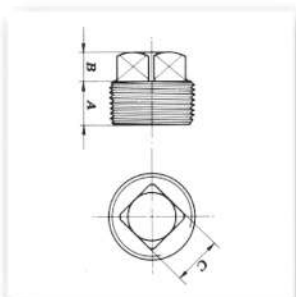

Tappi Testa Quadra **ASTM A105 A182 F304/304L F316/316L**

Ø	1/8"	1/4"	3/8"	1/2"	3/4"	1"	1.1/4"	1.1/2"	2"	2.1/2"	3"	4"	
3/6000	A	9.6	11.2	12.7	14.2	15.7	19.0	20.6	20.6	22.3	26.9	28.4	31.7
	B	35.0	41.1	41.1	44.5	44.5	50.8	50.8	50.8	63.5	69.8	69.8	76.2
	C	10.4	13.5	17.5	21.3	26.9	33.3	42.9	48.5	60.5	73.1	88.9	114.3

Raccordi Forgiati filettati in acciaio

Norma ANSI B16.11

Threaded ANSI B2.1 (NPT)

dimensioni espresse in mm

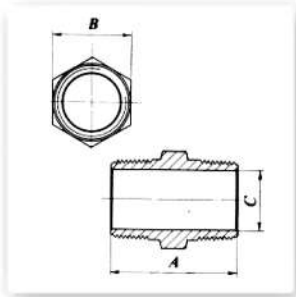

Nippli Esagonali **ASTM A105 A182 F304/304L F316/316L**

Ø	1/8"	1/4"	3/8"	1/2"	3/4"	1"	1.1/4"	1.1/2"	2"	2.1/2"	3"	4"	
2/3000	A	26.0	36.0	40.0	48.0	52.0	60.0	66.0	68.0	71.0	94.0	102.0	110.0
	B	11.0	15.0	18.0	22.0	27.0	35.0	45.0	50.0	62.0	76.0	93.0	119.0
	C		8.0	11.0	14.0	19.0	24.0	32.0	38.0	49.0	58.2	73.0	96.0
6000	B	26.0	36.0	40.0	48.0	52.0	60.0	66.0	68.0	71.0	94.0	102.0	110.0
	A	11.0	15.0	18.0	22.0	27.0	35.0	45.0	50.0	62.0	76.0	93.0	119.0
	C		6.0	8.0	11.0	13.0	17.0	24.5	30.0	39.0			

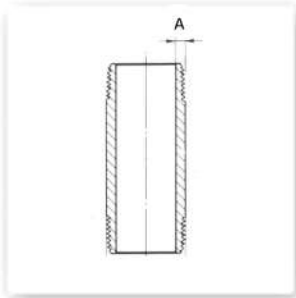

Nippli Tubo Filettati FxF **ASTM A106 A182 F304/304L F316/316L**

Ø	1/8"	1/4"	3/8"	1/2"	3/4"	1"	1.1/4"	1.1/2"	2"	2.1/2"	3"	4"	
s. 40	A	1.7	2.2	2.3	2.8	2.9	3.4	3.6	3.7	3.9	5.2	5.5	6.0
	B	lunghezze 50 100 150											
s. 80	A	2.4	3.0	3.2	3.7	3.9	4.6	4.8	5.1	5.5	7.0	7.6	8.6
	B	lunghezze 50 100 150											
s. 160	A				4.8	5.6	6.4	6.4	7.1	8.7	9.5	11.1	13.5
	B	lunghezze 50 100 150											

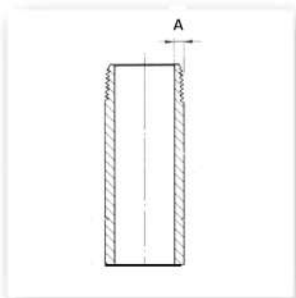

Mezzi Nippli Tubo FxP **ASTM A106 A182 F304/304L F316/316L**

Ø	1/8"	1/4"	3/8"	1/2"	3/4"	1"	1.1/4"	1.1/2"	2"	2.1/2"	3"	4"	
s. 40	A	1.7	2.2	2.3	2.8	2.9	3.4	3.6	3.7	3.9	5.2	5.5	6.0
	B	lunghezze 50 100 150											
s. 80	A	2.4	3.0	3.2	3.7	3.9	4.6	4.8	5.1	5.5	7.0	7.6	8.6
	B	lunghezze 50 100 150											
s. 160	A				4.8	5.6	6.4	6.4	7.1	8.7	9.5	11.1	13.5
	B	lunghezze 50 100 150											

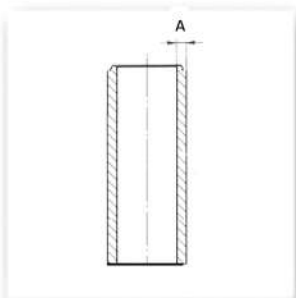

Nippli Tubo Piani PxP **ASTM A106 A182 F304/304L F316/316L**

Ø	1/8"	1/4"	3/8"	1/2"	3/4"	1"	1.1/4"	1.1/2"	2"	2.1/2"	3"	4"	
s. 40	A	1.7	2.2	2.3	2.8	2.9	3.4	3.6	3.7	3.9	5.2	5.5	6.0
	B	lunghezze 50 100 150											
s. 80	A	2.4	3.0	3.2	3.7	3.9	4.6	4.8	5.1	5.5	7.0	7.6	8.6
	B	lunghezze 50 100 150											
s. 160	A				4.8	5.6	6.4	6.4	7.1	8.7	9.5	11.1	13.5
	B	lunghezze 50 100 150											

dimensioni espresse in mm

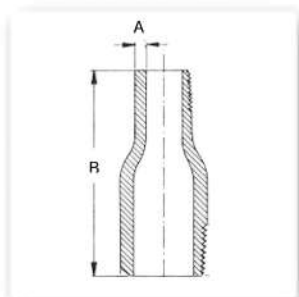

Nippli Tubo Ridotti Concentrici ASTM A106 A182 F304/304L F316/316L

Ø		1/8"	1/4"	3/8"	1/2"	3/4"	1"	1.1/4"	1.1/2"	2"	2.1/2"	3"	4"
S. 40	A	1.7	2.2	2.3	2.8	2.9	3.4	3.6	3.7	3.9	5.2	5.5	6.0
	B		69.9	69.9	69.9	76.2	88.9	101.6	114.3	165.1	178.0	203.0	228.0
S. 80	A	2.4	3.0	3.2	3.7	3.9	4.6	4.8	5.1	5.5	7.0	7.6	8.6
	B		69.9	69.9	69.9	76.2	88.9	101.6	114.3	165.1	178.0	203.0	228.0
S. 160	A				4.8	5.6	6.4	6.4	7.1	8.7	9.5	11.1	13.5
	B				69.9	76.2	88.9	101.6	114.3	165.1	178.0	203.0	228.0

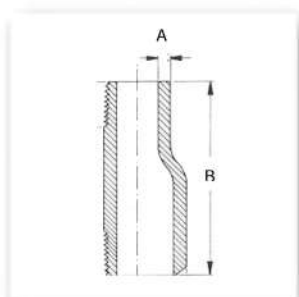

Nippli Tubo Ridotti Eccentrici A106 A182 F304/304L F316/316L

Ø		1/8"	1/4"	3/8"	1/2"	3/4"	1"	1.1/4"	1.1/2"	2"	2.1/2"	3"	4"
S. 40	A	1.7	2.2	2.3	2.8	2.9	3.4	3.6	3.7	3.9	5.2	5.5	6.0
	B		69.9	69.9	69.9	76.2	88.9	101.6	114.3	165.1	178.0	203.0	228.0
S. 80	A	2.4	3.0	3.2	3.7	3.9	4.6	4.8	5.1	5.5	7.0	7.6	8.6
	B		69.9	69.9	69.9	76.2	88.9	101.6	114.3	165.1	178.0	203.0	228.0
S. 160	A				4.8	5.6	6.4	6.4	7.1	8.7	9.5	11.1	13.5
	B				69.9	76.2	88.9	101.6	114.3	165.1	178.0	203.0	228.0

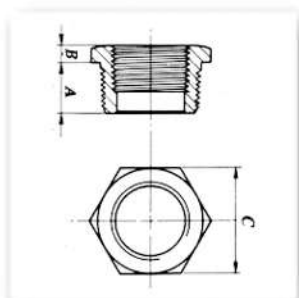

Riduzioni esagonali ASTM A105 A182 F304/304L F316/316L

Ø		1/8"	1/4"	3/8"	1/2"	3/4"	1"	1.1/4"	1.1/2"	2"	2.1/2"	3"	4"
3/6000	A	9.6	11.2	12.7	14.2	15.7	19.0	20.6	20.6	22.3	26.9	28.4	31.7
	B	6.3	6.3	7.9	7.9	9.6	9.6	14.2	15.7	17.5	19.0	20.6	31.7
	C	11.0	16.0	17.5	22.0	27.0	35.0	44.5	51.0	63.5	76.0	89.0	117.5

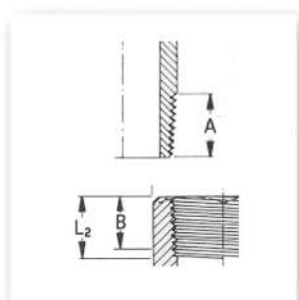

Atezza e Profondità filetti

Ø		1/8"	1/4"	3/8"	1/2"	3/4"	1"	1.1/4"	1.1/2"	2"	2.1/2"	3"	4"
2/3/6000	A	9.6	11.2	12.7	14.2	15.7	19.0	20.6	20.6	22.3	26.9	28.4	31.7
	B	6.4	8.1	9.1	10.9	12.7	14.7	17.0	17.8	19.0	23.6	25.9	27.7
		Lunghezza minima del filetto con profilo pieno											
L ₂	6.7	10.2	10.4	13.6	13.9	17.3	17.9	18.4	19.2	28.9	30.5	33.0	
	Lunghezza minima del filetto interno utile												