

dimensioni espresse in mm

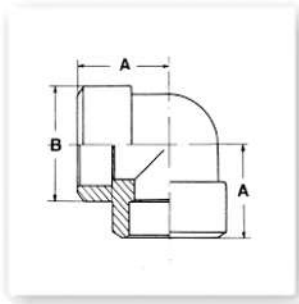

Gomiti a 90° ASTM A105 A182 F304/304L F316/316L

Ø	1/8"	1/4"	3/8"	1/2"	3/4"	1"	1.1/4"	1.1/2"	2"	2.1/2"	3"	4"	
3000	A	20.5	20.5	24	28	33	37.5	44	50.5	60	76	82	114
	B	22	22	26	33.5	38.5	46	56	62	75.5	92	110	159
6000	A	20.5	24	28	33	37.5	44	50.5	60	63	82	95	114
	B	22	26	33.5	33.5	46	56	62	75.5	84.5	110	124	159

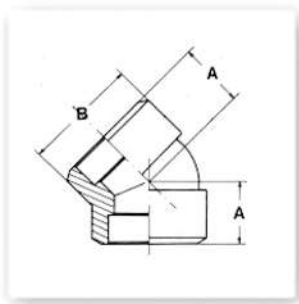

Gomiti a 45° ASTM A105 A182 F304/304L F316/316L

Ø	1/8"	1/4"	3/8"	1/2"	3/4"	1"	1.1/4"	1.1/2"	2"	2.1/2"	3"	4"	
3000	A	17.5	17.5	19	22	25.5	28.5	33.5	36.5	43	52	53	80
	B	22	22	26	33.5	38.5	46	56	62	75.5	92	110	159
6000	A	17.5	19	22	25.5	28.5	33.5	36.5	43	52	63	63	80
	B	22	26	33.5	33.5	46	56	62	75.5	84.5	110	124	159

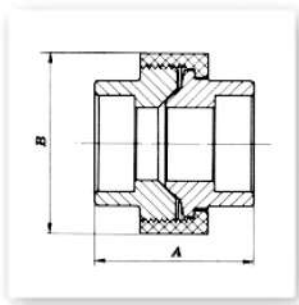

Bocchettoni ASTM A105 A182 F304/304L F316/316L

Ø	1/8"	1/4"	3/8"	1/2"	3/4"	1"	1.1/4"	1.1/2"	2"	2.1/2"	3"	4"	
3000	A	43	43	46	51	56	63	75	82	94	114	130	176
	B	36	36	41	46	56	65	78	88	105	122	144	176
6000	A	-	54	57	69	74	78	89	108	114	-	-	-
	B	-	46	51	60	72	86	94	100	122	-	-	-

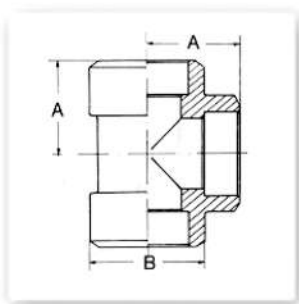

Tee Normali ASTM A105 A182 F304/304L F316/316L

Ø	1/8"	1/4"	3/8"	1/2"	3/4"	1"	1.1/4"	1.1/2"	2"	2.1/2"	3"	4"	
3000	A	20.5	20.5	24	28	33	37.5	44	50.5	60	76	82	114
	B	22	22	26	33.5	38.5	46	56	62	75.5	92	110	159
6000	A	20.5	24	28	33	37.5	44	50.5	60	63	82	95	114
	B	22	26	33.5	33.5	46	56	62	75.5	84.5	110	124	159

dimensioni espresse in mm

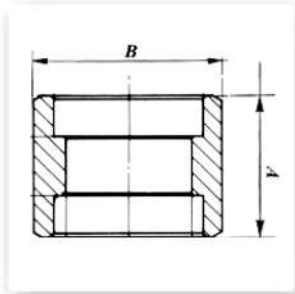

Manicotti **ASTM A105 A182 F304/304L F316/316L**

Ø	1/8"	1/4"	3/8"	1/2"	3/4"	1"	1.1/4"	1.1/2"	2"	2.1/2"	3"	4"	
3000	A	-	25.5	25.5	28.5	35.5	39	39	39	51	51	51	60
	B	-	22	25	32	38	45	55	60	75	90	108	135
6000	A	-	25.5	25.5	28.5	35.5	39	39	39	51	51	51	60
	B	-	23	26.5	33	40	50	58	65	82	96	118	149

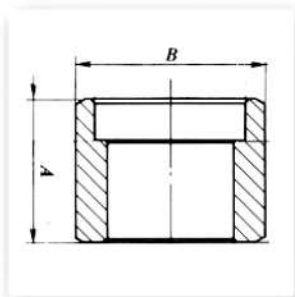

Mezzi manicotti **ASTM A105 A182 F304/304L F316/316L**

Ø	1/8"	1/4"	3/8"	1/2"	3/4"	1"	1.1/4"	1.1/2"	2"	2.1/2"	3"	4"	
3000	A	-	25.5	27	32	37	41.5	43.5	45	57.5	59	60.5	70
	B	-	22	25	32	38	45	55	60	75	90	108	135
6000	A	-	25.5	27	32	37	41.5	43.5	45	57.5	59	60.5	70
	B	-	23	26.5	33	40	50	58	65	82	96	118	149

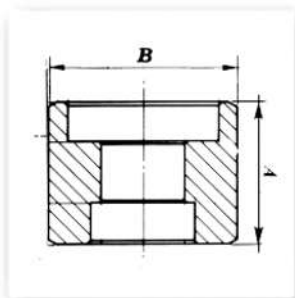

Manicotti ridotti **ASTM A105 A182 F304/304L F316/316L**

Ø	1/8"	1/4"	3/8"	1/2"	3/4"	1"	1.1/4"	1.1/2"	2"	2.1/2"	3"	4"	
3000	A	-	25.5	25.5	28.5	35.5	39	39	39	51	51	51	60
	B	-	22	25	32	38	45	55	60	75	90	108	135
6000	A	-	25.5	25.5	28.5	35.5	39	39	39	51	51	51	60
	B	-	23	26.5	33	40	50	58	65	82	96	118	149

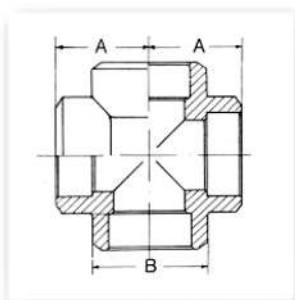

Croci **ASTM A105 A182 F304/304L F316/316L**

Ø	1/8"	1/4"	3/8"	1/2"	3/4"	1"	1.1/4"	1.1/2"	2"	2.1/2"	3"	4"	
3000	A	20.5	20.5	24	28	33	37.5	44	50.5	60	76	82	114
	B	22	22	26	33.5	38.5	46	56	62	75.5	92	110	159
6000	A	20.5	24	28	33	37.5	44	50.5	60	63	82	95	114
	B	22	26	33.5	33.5	46	56	62	75.5	84.5	110	124	159

dimensioni espresse in mm

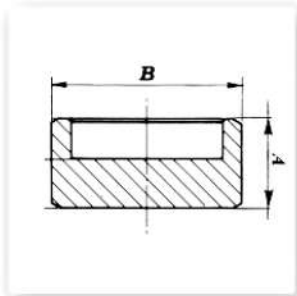

Tabbi Femmina ASTM A105 A182 F304/304L F316/316L

Ø	1/8"	1/4"	3/8"	1/2"	3/4"	1"	1.1/4"	1.1/2"	2"	2.1/2"	3"	4"	
3000	A	-	16	16	17.5	22.5	25	26	28	34	37	40	45
	B	-	22	25	32	38	45	55	60	75	90	108	135
6000	A	-	17.5	19	21	26	28	31	33	40	45	50	60
	B	-	23	27	33	40	50	58	65	82	96	118	149

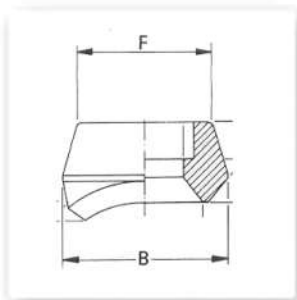

Socketlet ASTM A105 A182 F304/304L F316/316L

Ø	1/8"	1/4"	3/8"	1/2"	3/4"	1"	1.1/4"	1.1/2"	2"	2.1/2"	3"	4"	
3000	F	22.2	22.2	25.4	31.7	36.5	46.0	55.6	61.9	74.6	87.3	104.8	130.2
	B	25.4	25.4	31.8	34.9	44.5	54.0	65.1	73.0	88.9	103.2	122.2	152.4
6000	F	-	-	-	36.7	45.2	57.1	65.1	76.2	92.1	-	-	-
	B	-	-	-	44.5	50.8	61.9	69.9	82.6	103.2	-	-	-

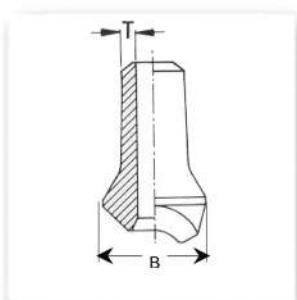

Nippolet ASTM A105 A182 F304/304L F316/316L

Ø	1/8"	1/4"	3/8"	1/2"	3/4"	1"	1.1/4"	1.1/2"	2"	2.1/2"	3"	4"	
3000 XS	T	-	-	-	3.7	3.9	4.5	4.8	5.1	5.5	-	-	-
	B	-	-	-	34.9	44.5	54.0	65.1	73.0	88.9	-	-	-
6000 160	T	-	-	-	4.8	5.6	6.3	6.3	7.1	8.7	-	-	-
	B	-	-	-	34.9	44.5	50.8	61.9	69.9	81.0	-	-	-

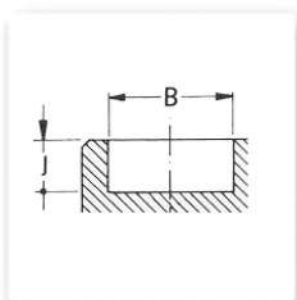

Diametri e Profondità Tasche

Ø	1/8"	1/4"	3/8"	1/2"	3/4"	1"	1.1/4"	1.1/2"	2"	2.1/2"	3"	4"	
B	Max	10.9	14.3	17.8	22.0	27.3	34.1	42.8	48.9	61.4	74.2	90.2	115.8
	Min	10.7	14.1	17.5	21.7	27.0	33.8	42.5	48.6	61.1	73.8	89.8	115.4
J	9.7	9.7	9.7	9.7	12.7	12.7	12.7	12.7	15.7	15.7	15.7	19.0	